

# Fast Crew Supplier 2710

STANDARD



## PICTURE OF SIMILAR VESSEL

### GENERAL

Hull material	Aluminium
Superstructure material	Aluminium
Basic functions	Crew and cargo duties
Classification	Bureau Veritas
	1 * Hull • MACH
	Light Ship / Fast Utility Vessel
	Sea Area 3

### DIMENSIONS

Length overall	26.8 m
Beam overall	10.5 m
Depth at sides	4.3 m
Draught max	2.3 m
Deadweight max	Up to 30.0 t
Cargo deck area	90.0 m <sup>2</sup>
Deck load	1.5 t/m <sup>2</sup>
Deck cargo	Up to 20.0 t
Gross tonnage	235
Crew	Up to 14 persons
(Industrial) personnel	Up to 24 persons

### TANK CAPACITIES

Fuel oil	30.5 m <sup>3</sup>
Fresh water	3.5 m <sup>3</sup>
Sewage	0.5 m <sup>3</sup>
Bilge water/ dirty oil	0.4 m <sup>3</sup>

### PERFORMANCES

Speed	Up to 25.0 kn
Range at max. speed	1,200 nm

### PROPULSION SYSTEM

Main engines	2x Caterpillar C32 TTA
Total power	Up to 2,162 kW
Gearboxes	2x Reintjes ZWVSA series (two-speed)
Propulsion	2x Fixed pitch propeller
Bow thrusters	2x 64 kW, hydraulically driven

### ELECTRICAL EQUIPMENT

Network	24V dc, 400/230V 50 Hz AC
Generator set	2x 38.0 kW

### DECK LAY-OUT

Anchor equipment	1x 150 kg SHHP Pool TW, chain, electric winch
Fendering	Heavy-duty bow fender, rubber "D" type at sides

### SHIP SYSTEMS

Ship systems are according to Class	
Fuel transfer system	2x pump, electrically driven
Engine room ventilation	2x Extraction fan, 8,000 m <sup>3</sup> /hr each (one fan in each engine room)
Air-conditioning	Up to 108,000 BTU/hr
Fire extinguishing	Novec 1230 in engine rooms

### ACCOMMODATION

Bridge deck	Wheelhouse, crew mess
Main deck	Personnel area, crew cabins, wet gear room, pantry, mess room, sanitary spaces
Lower deck	Storage

### NAUTICAL AND COMMUNICATION EQUIPMENT

Integrated navigation system	
Remote monitoring system	
Searchlight	1x
Radar	1x X-band
AIS	1x
Compass	1x Magnetic, 1x GPS
Autopilot	1x
Echo sounder	1x
Internal communications	Intercom and loudhailer
External communications	GMDSS A2
Weather system	1x

### OPTIONAL

Flag	HS-OSC (MCA, BG Verkehr, DMA, ILT), St. Vincent
Bilge water separator	1x 0.5 m <sup>3</sup> /hr
Moonpool	
Electric network	440/220 V 60 Hz AC
	Consumer network
Hoisting equipment	Foldable deck crane, up to 20 tm
Rescue zone	
Rescue cradle	1 extra unit, 12,500 BTU/hr
Fuel cargo system	
Crew accommodation	Up to 4 additional crew cabins (lower deck)
Personnel accomm	Alternative seats (VIP), alternative layout
Various navigation equipment	
CCTV system	
External communication	GMDSS A3
Data communication	Iridium, V-SAT, Fleet broadband, 4G, Wi-Fi system, LAN system

# Fast Crew Supplier 2710

STANDARD

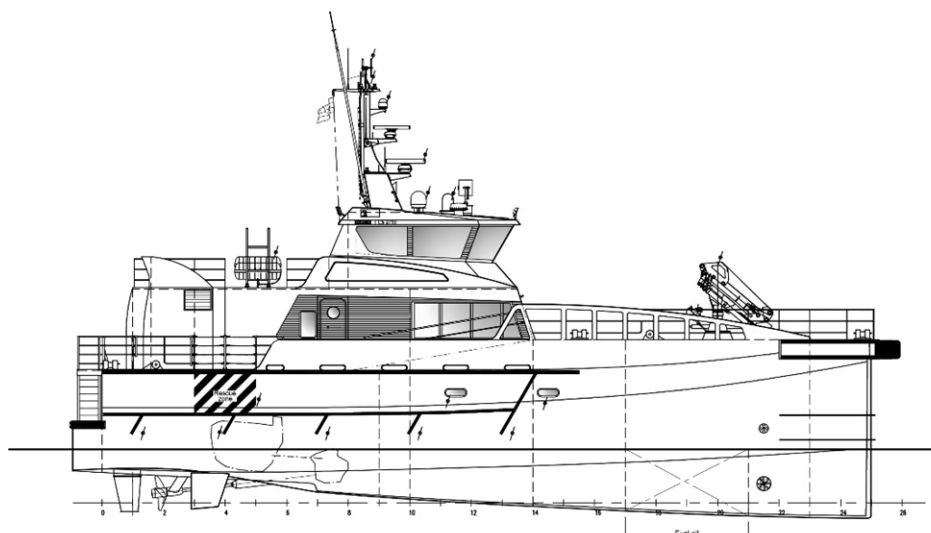

Profile

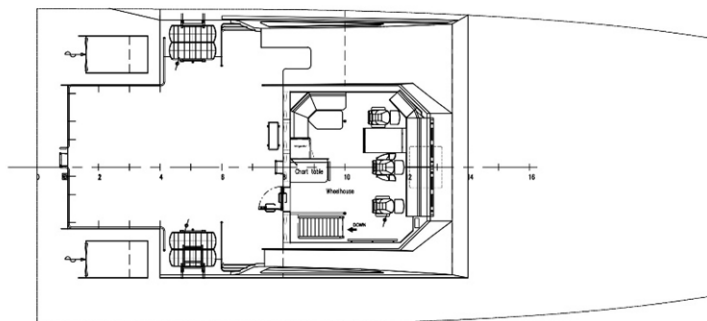

Bridge deck

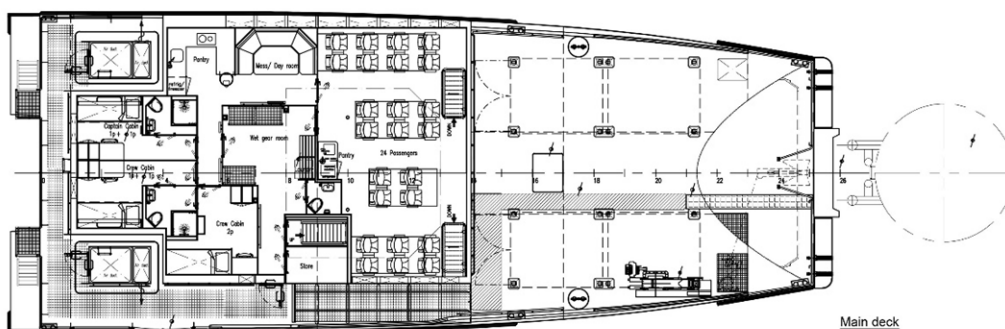

Main deck

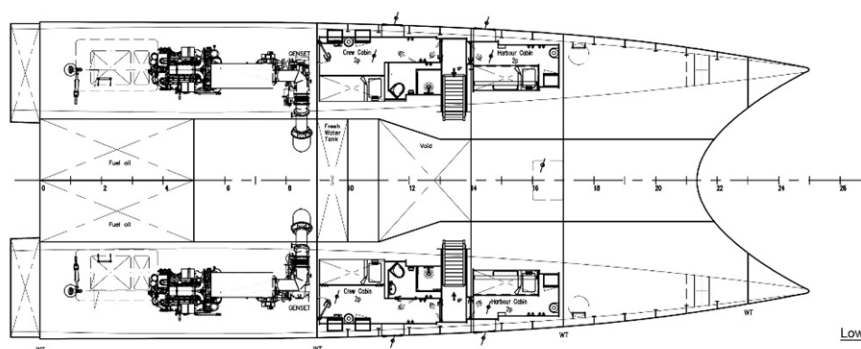

Lower deck

Items marked with are optional equipment

**DAMEN**

Damen.com

©This product sheet is designed to inform about Damen and its product(s). All data presented is preliminary and subject to changes. No rights can be derived from this information with regard to dimensions, characteristics or performances of any of the products shown. Damen is not liable for the consequence of taking on the information from the product sheet. The entire contents of this product sheet (text, drawings, photos, etc.) is copyrighted and may not be reproduced or distributed without the specific written permission of Damen.